

## Promax TDG50 Line Borer



**TDG50 Line Boring** is a lightweight, portable, line boring machine, it can be adapted to variety of the narrow space, high-altitude complex processing needs. It combines our more than 15 years of experience on site engineering service, advanced industry design concept and field boring capability.

### **Gearbox System**

Integrated rotation drive unit and auto feed unit together creatively, only 9.5KG, more portable, step less Speed regulation range 0 to 0.5mm, easily achieve the forward and reverse exchange.

### **Easy Set Up**

Equipped 3 legs mount kit, which can be adjusted to different angle, to meet different holes.

### **Measuring tools**

Equipped with bore cutter measuring tool and diameter measuring ruler.

### **Superior scalability**

- Optional one smaller boring bar to achieve boring diameter  $\varnothing 38-300\text{mm}$ .
- Optional facing head, to achieve face processing of pipe and flanges.
- Optional bore welder used for integrated line boring and welding system.

### **Application**

This machine with powerful machining capacity which widely service for many fields, repairing holes in heavy construction equipment, such as cranes, excavators, bulldozers, tractors, back holes etc.

# Technical Details

Model	TDG50	TDG50PLUS
Boring Dia	55-300mm	38-300mm
Boring Stroke	280 mm	
Feed Rate	0-0.5mm/rev	
Drive Power Unit	1800W, 230V/110V,50/60Hz	
Bar rpm	0-49/0-98	
Boring Bar	Ø50*1828mm	Ø50*1828mm Ø35*1200mm
Shipping Weight	98KG	123KG

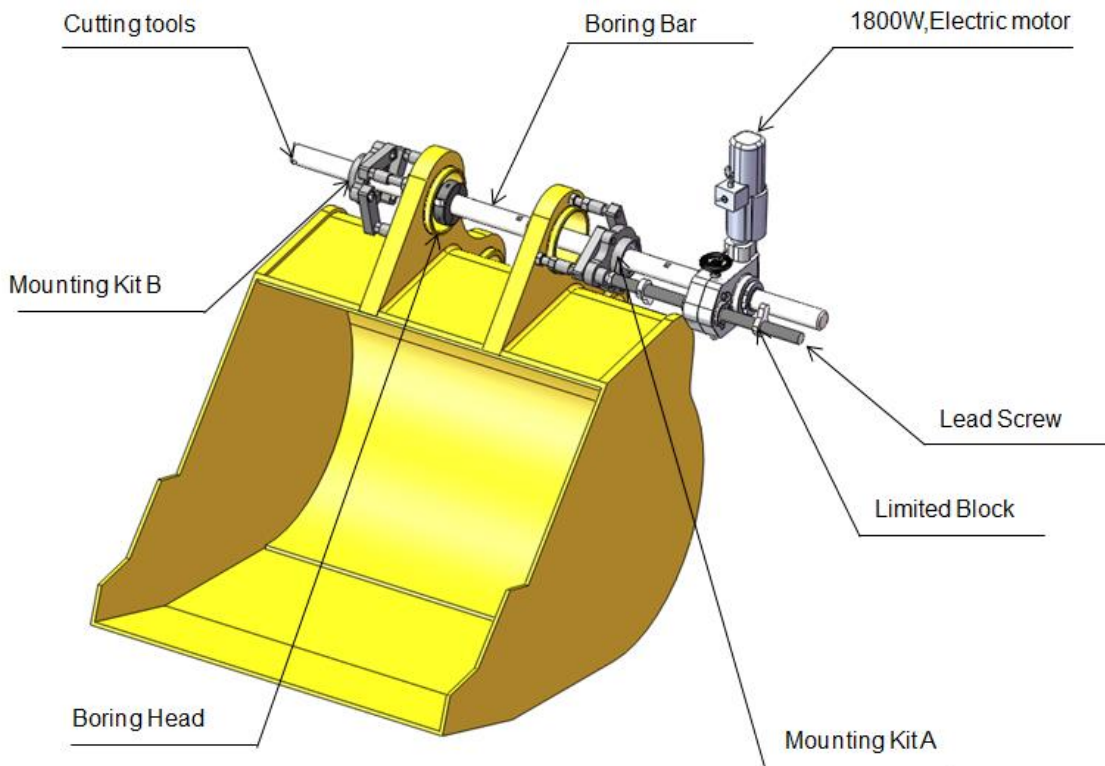

# Select Configuration

## » Drive Gearbox (102011)

- Mechanical feed, feed rate:0-0.5mm/rev
- Can be mounted anywhere on the bar.

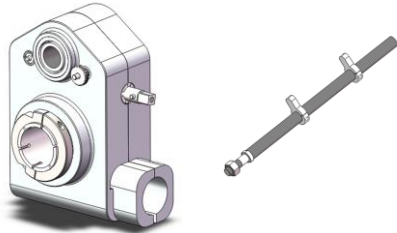

## » Lead Screw

- 280mm Feed stock ( 102030)

## » Boring Bar

- All bars are made of 42CrMo chrome-plated steel.
- Tooling hole spaced every 200mm.

Bar Dia	Bar Length	Hole Size	Code
50	1200	16	102061
50	1828	16	102062
50	2438	16	102065
35	1200	12	102063
35	1828	12	102064

## » Mounting Kit

- Mounting range: 55-300mm.
- Support of machines complete with brackets to knee.
- Mounting Kit B with spherical bearings.(102110)



Mounting Kit B

## » Drive Motor

Made in Germany, 2 bar speeds, 0-49 / 0-98rpm, weight: 6.8kg

- Single phase,110V, 50/60Hz, 1800W(104131)
- Single phase,230V, 50/60Hz, 1800W(104132)

## » Bore Heads(102050)

- Fit to Ø50mm bar.
- 16\*16mm square cutter.
- Boring diameter: Ø120-165mm、Ø150-230mm.  
Ø200-280mm、Ø250-300mm.

## » Rapid Centering System

Magnet mounting, Max control range:350mm.

Model	Code
Fit to 50mm bar and 35mm bar	102071
Fit to 50mm bar	102070

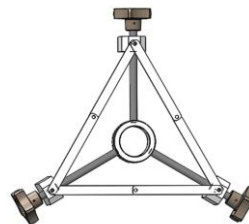

## » Cutter Measuring Tool

- Digital calipers.
- Used to measuring cutter out the length of bar.

Model	Code
Fit to 35mm bar	102081
Fit to 50mm bar	102080



»» **Reduction Sleeve(102150)**

- Fit to Ø35mm bar.
- Includes:1 Drive Gearbox sleeves  
2 Bearing sleeves

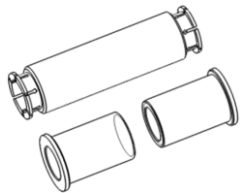

»» **Bore Measuring Tool**

- Digital calipers(102091).
- Metric and Inch scale readouts.
- Measurement:10-300mm.

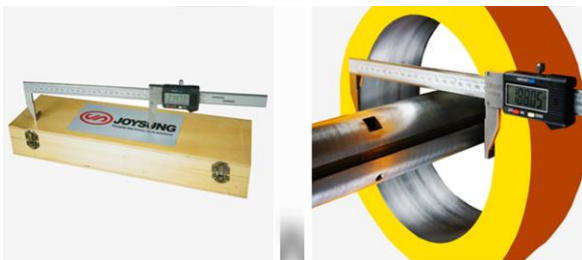

»» **Facing Head**

- Fit to Ø50mm bar.
- 16\*16mm square cutter.
- Using facing head to machining face the extension block are required to achieve rotating space.

Facing Diameter	Code
80-380mm	103121
120-450mm	103122

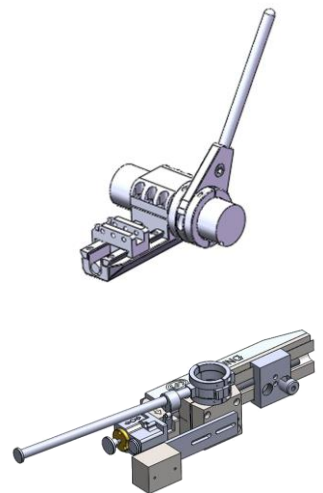

»» **Tool Kit**

Model	Code
12mm inserted tool holder,45	1041402
16mm inserted tool holder,lh,90	1041403
Carbide Insert for 12mm tool holder, 11T304L-G	104510
Carbide Insert for 16mm tool holder, 160404L-S	104511

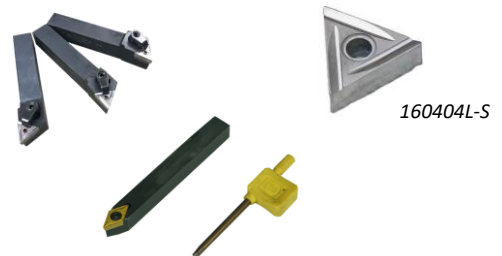

»» **Bore Welder**

Model	Code
Facing diameter: 80-380mm	103121
Facing diameter: 120-450mm	103122



# Standard Configuration

## TDG50 Line Boring

Code	Description	Qty
102062	Boring Bar : Ø50*1828mm	1
102011	Drive gearbox	1
102090	Hand wheel	1
102030	Lead screw with Limit block	1
102130	Drive power unit,1800W,230V/110V,50/60Hz	1
102100	Mounting Kit A	1
102110	Mounting Kit B	1
102070	Rapid centering system (50mm) (1set-2pcs)	1
102050	Bore heads(1set - 4pcs)	1
102080	Cutter measuring tool	1
1041403	16mm inserted tool holder	1
104511	Carbide Insert for 16mm tool holder, 160404L-S	3
102170	Tool Pack	1
102180	Shipping Box	2

### Packing Size

Box 1	640mm * 440mm * 340mm
Box 2	1900mm * 90mm * 90mm

### Shipping Weight

Box 1	75Kg
Box 2	30Kg



## Optional Accessories

Code	Description	Qty
103121	Facing Head,80-380mm, weight: 8kg	
103122	Facing Head,120-450mm, weight:14.5kg	
104510	Carbide Insert for 12mm tool holder, 11T304L-G	
104511	Carbide Insert for 16mm tool holder, 160404L-S	
104161	BW350 Auto Bore Welder, weight: 42kg	
104162	BW360 Auto Bore Welder, weight: 45kg	
102091	Bore Measuring Tool,10-300mm	



# Standard Configuration

## TDG50 PLUS Line Boring

Code	Description	Qty
102062	Boring Bar : Ø50*1828mm	1
102063	Boring Bar : Ø35*1200mm	1
102011	Drive gearbox	1
102190	Hand wheel	1
102030	Lead screw with Limit block	1
102130	Drive power unit,1800W,230V/110V,50/60Hz	1
102100	Mounting Kit A	1
102110	Mounting Kit B	1
102071	Rapid centering system (50/35mm) (1set-2pcs)	1
102150	Reduction sleeve(1set - 3pcs)	1
102050	Bore heads(1set - 4pcs)	1
102081	Cutter measuring tool:35mm	1
102080	Cutter measuring tool:50mm	1
1041403	16mm inserted tool holder	1
1041402	12mm inserted tool holder	1
104511	Carbide Insert for 16mm tool holder, 160404L-S	3
104510	Carbide Insert for 12mm tool holder, 11T304L-G	3
102170	Tool Pack	1
102180	Shipping Box	2

### Packing Size

Box 1	640mm * 440mm * 340mm
Box 2	1900mm * 90mm * 90mm

### Shipping Weight

Box 1	85Kg
Box 2	38Kg



### Optional Accessories

Code	Description	Qty
103121	Facing Head,80-380mm, weight:8kg	
103122	Facing Head,120-450mm, weight:14.5kg	
104510	Carbide Insert for 12mm tool holder, 11T304L-G	
104511	Carbide Insert for 16mm tool holder, 160404L-S	
104161	BW350 Auto Bore Welder, weight: 42kg	
104162	BW360 Auto Bore Welder, weight: 45kg	
102091	Bore Measuring Tool,10-300mm	

# Applications

